

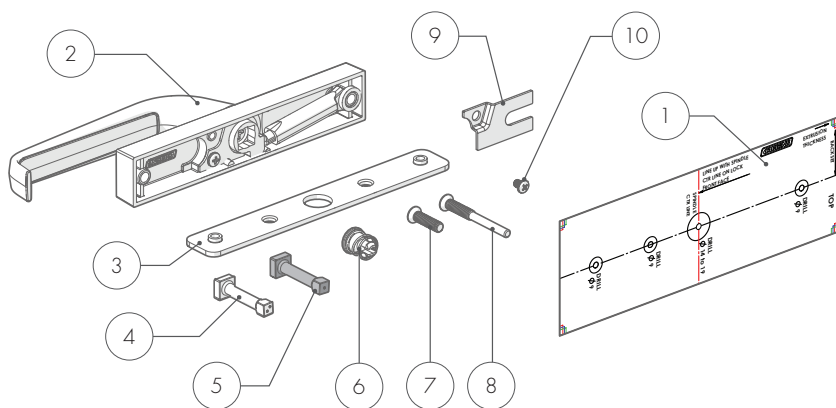

# CFB-EH FLIP BOLT MORTICE LOCK - EGRESS HANDLE

## 1. EGRESS HANDLE COMPONENT PART LIST



Item No.	Description	QTY
1	Drill Template	1
2	Egress Handle	1
3	Mounting Plate	1
4	Left-hand Spindle	1
5	Right-hand Spindle	1
6	Mounting Plate Clip	1
7	Bottom Mounting Screw	1
8	Top Mounting Screw Pin	1
9	Spindle Plate	1
10	Spindle Screw	1

## REFERENCE DIMENSIONS FOR EGRESS HANDLE INSTALLATION

### REFERENCE DIMENSIONS

Install Egress Handle using drilling template (next page)

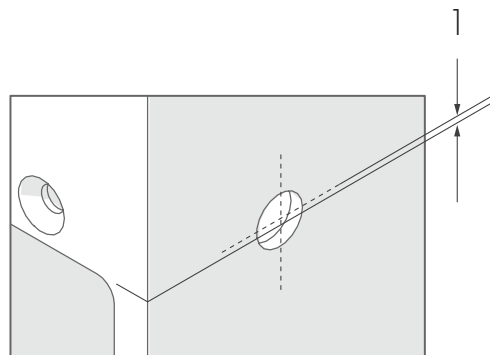
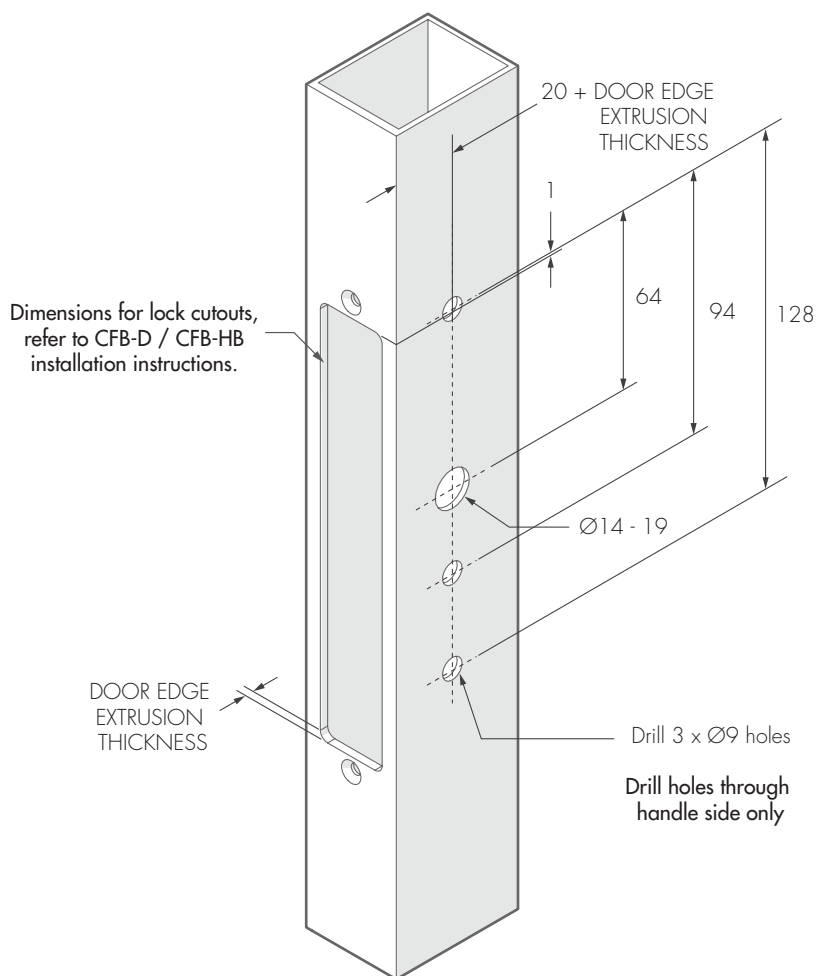

### Special Notes:

For lock installation instructions, please refer to installation instructions provided with CFB-D / CFB-HB.

For installation together with CLS-FAB - Flip Bolt Latching Strike, please refer to the installation instructions provided with CLS-FAB.

For installation together with CFB-OCEP - Oval Cylinder Rectangular Escutcheon, please refer to the installation instructions provided with CFB-OCEP.

**WARNING**  
Please keep contents away from small children.  
Suffocation Hazard.

**NOTE**  
Please dispose of plastic bags and other packaging in a thoughtful manner



**LOCK & KEY** Phone: 1300 652 692 Web: [www.locknkey.com.au](http://www.locknkey.com.au)

Distributed in Australia by  
LOCK AND KEY a division on the  
DAYCOR GROUP PTY LTD ABN 95 003 562 598  
This product has been manufactured in China  
to Lock and Key Company specifications

This product is guaranteed to be free from defects in materials and  
workmanship for a period of one (1) year from the date of original  
purchase. This warranty is for replacement of product only and Lock  
and Key Company does not accept responsibility for any direct or  
consequential damage caused by this product or its use. This warranty

Web: [www.daveweb.com.au](http://www.daveweb.com.au)

does not cover damage that results from faulty installation or usage,  
alteration or modification of the product or tarnishing of the finish,  
including colour change due to weather, salt or chemical. Should this  
product not perform satisfactorily in its intended application, return it  
to place of purchase for replacement.



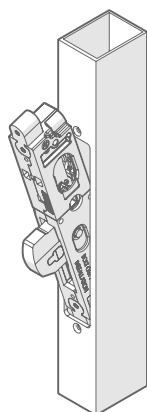

**CFB-EH FLIP BOLT MORTICE LOCK - EGRESS HANDLE**
**2. DRILLING TEMPLATE INSTRUCTIONS**

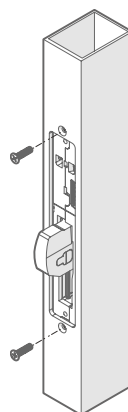
**2A** Insert lock into door cavity.  
ENSURE BOLT IS  
EXTENDED.

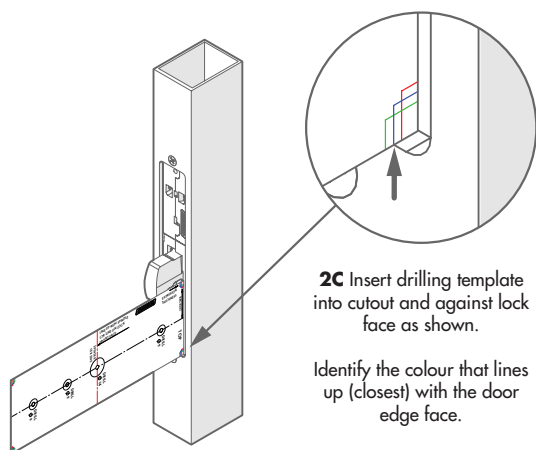

**2B** Secure with  
2x M4x16mm CSK  
Screws (supplied  
with lock).



**2C** Insert drilling template  
into cutout and against lock  
face as shown.

Identify the colour that lines  
up (closest) with the door  
edge face.

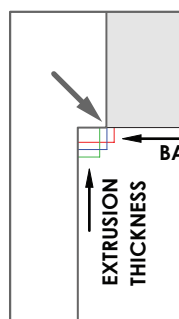

**2D** To determine the correct  
backset position, align the  
corresponding same coloured line  
at the top and bottom, as shown  
on the diagram.  
Ensure template is straight.

To determine the vertical position  
of the template, align the spindle  
ctr line with the spindle line on the  
lock

Mark drilling holes.

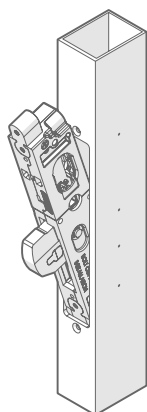
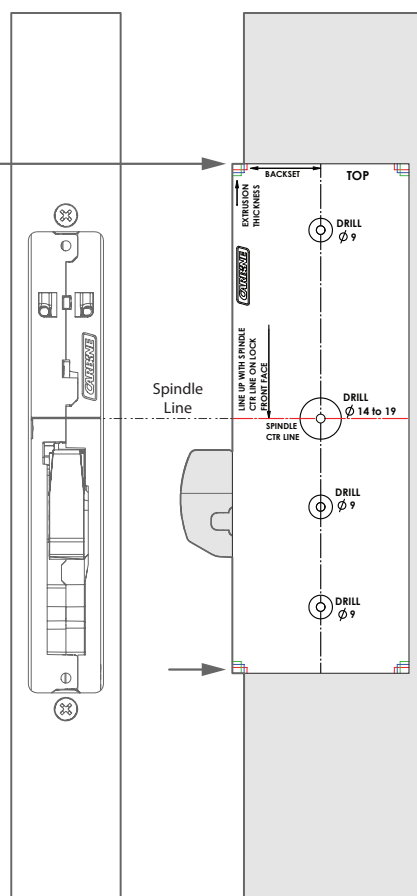

**2E** Remove the 2x  
M4x16mm CSK  
Screws and lock  
from the door.

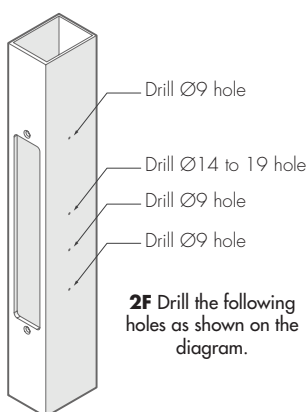

**2F** Drill the following  
holes as shown on the  
diagram.

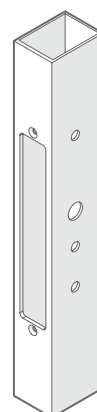

**2G** Preparation for installation of  
egress handle furniture and lock  
into metal door is now complete.

Continue with egress handle  
furniture installation  
instructions  
section 3.

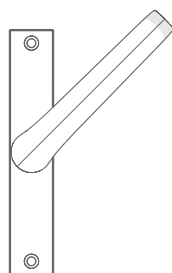
**CFB-EH FLIP BOLT MORTICE LOCK - EGRESS HANDLE**
**3. CHANGE OF HANDING - IF REQUIRED**

Left-hand 45° Configuration

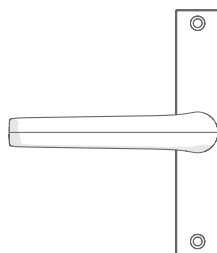

Right-hand Configuration

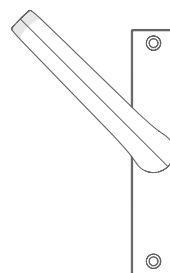

Right-hand 45° Configuration

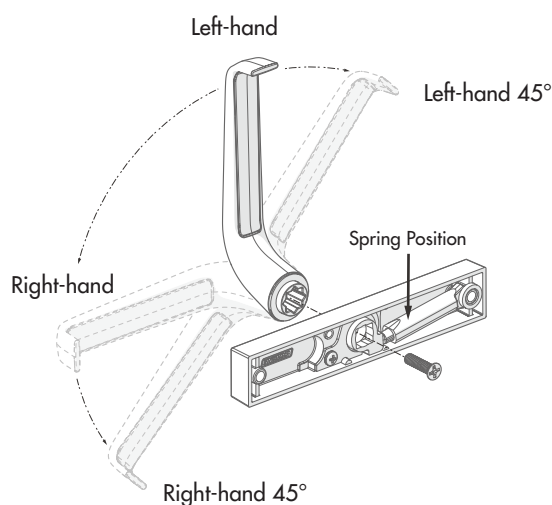

**3A** Remove screw and carefully pull handle and nylon bush off the faceplate and rotate handle at desired configuration as shown on the diagram.

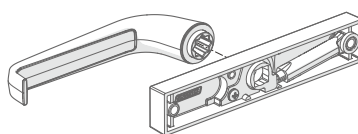

**3B** Place handle and nylon back into faceplate.

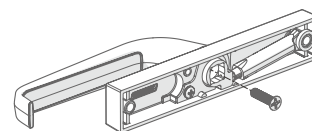

**3C** Securely re-tighten handle retention screw back into handle.

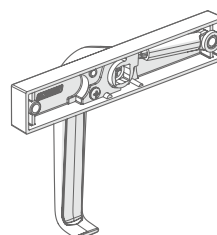

**3D** Test operation to ensure change of handing is correct.

**For left-hand furniture, proceed to step 4A for installation of spindle for left-hand furniture. Alternatively for right-hand furniture, proceed to step 4B for installation of spindle for right-hand furniture.**

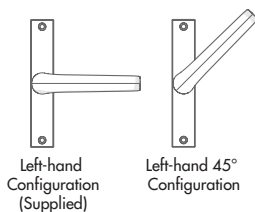
**4A. INSTALLATION OF SPINDLE FOR LEFT-HAND DOOR FURNITURE**
**4B. INSTALLATION OF SPINDLE FOR RIGHT-HAND DOOR FURNITURE**

LEFT-HAND SPINDLE (SILVER)

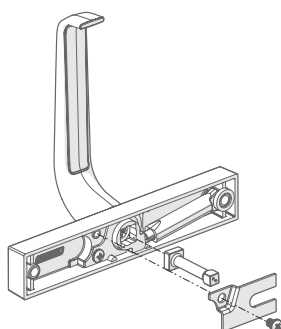
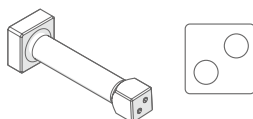

**4A.A** Insert silver left-hand spindle (two dots) into the hub of handle and replace the spindle plate and securely refasten screw.

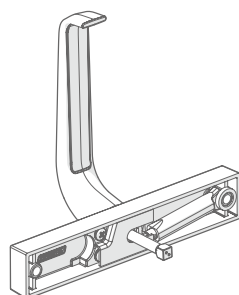

**4A.B** Ensure the handle is in the upright position for installation.

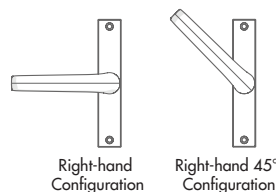

RIGHT-HAND SPINDLE (BLACK)

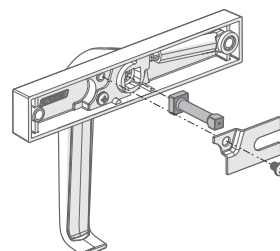
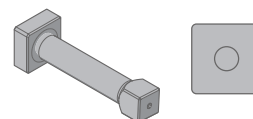

**4B.A** Insert black right-hand spindle (one dot) into the hub of handle and replace the spindle plate and securely refasten screw.

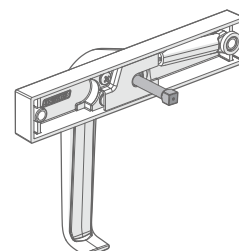

**4B.B** Ensure the handle is in the upright position for installation.



# CFB-EH FLIP BOLT MORTICE LOCK - EGRESS HANDLE

## 5. INSTALLATION OF MAIN LOCK AND EGRESS HANDLE

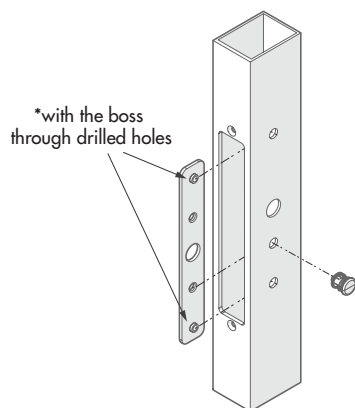

**5A** Insert mounting plate with bosses facing handle side into door cavity\*, do not drop inside door. Firmly press mounting plate clip through the door extrusion into the mounting plate.

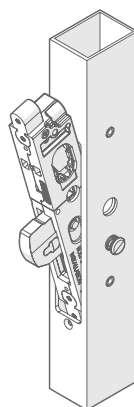

**5B** Insert CFB-D / CFB-HB lock into door cavity. ENSURE BOLT IS EXTENDED.

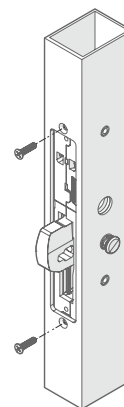

**5C** Secure with 2x M4x16mm CSK Screws (supplied with lock).

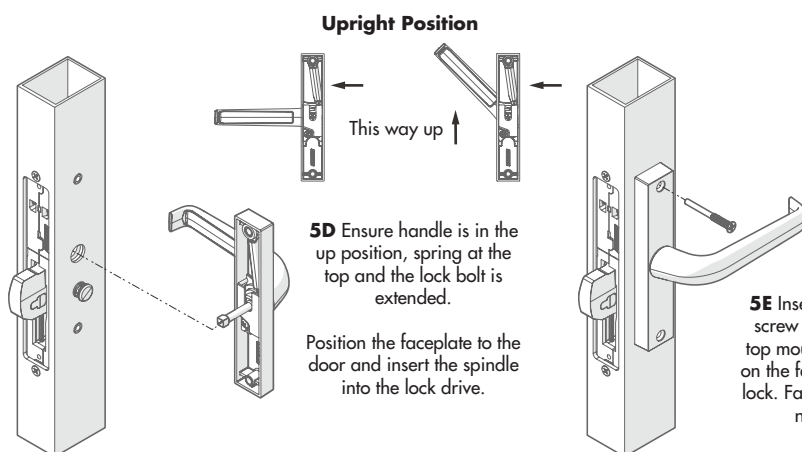

**5D** Ensure handle is in the up position, spring at the top and the lock bolt is extended.

Position the faceplate to the door and insert the spindle into the lock drive.

**5E** Insert top mounting screw pin through the top mounting plate hole on the faceplate and into lock. Fasten to retain, do not tighten.

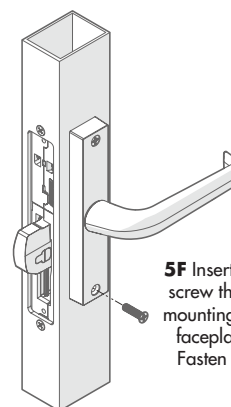

**5F** Insert bottom mounting screw through the bottom mounting plate hole on the faceplate and into lock. Fasten to retain, do not tighten.

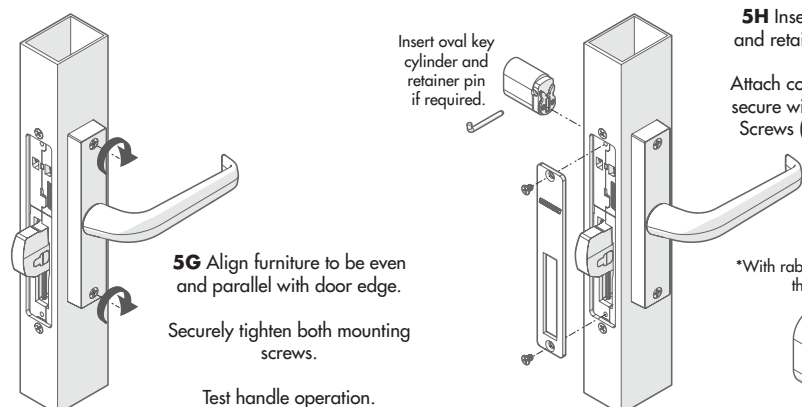

**5G** Align furniture to be even and parallel with door edge.

Securely tighten both mounting screws.

Test handle operation.

**5H** Insert oval key cylinder and retainer pin if required.\*

Attach cover plate to lock and secure with 2x M4x6mm CSK Screws (supplied with lock).

\*With rabbit ear / R cam fitted on the oval cylinder.



**5I** Installation is now complete.

### Special Notes:

For lock installation instructions, please refer to installation instructions provided with CFB-D / CFB-HB.

For installation together with CLS-FAB - Flip Bolt Latching Strike, please refer to the installation instructions provided with CLS-FAB.

For installation together with CFB-OCEP - Oval Cylinder Rectangular Escutcheon, please refer to the installation instructions provided with CFB-OCEP.

**WARNING**  
Please keep contents away from small children. Suffocation Hazard.

**NOTE**  
Please dispose of plastic bags and other packaging in a thoughtful manner.



**LOCK & KEY** Phone: 1300 652 692 Web: [www.locknkey.com.au](http://www.locknkey.com.au) Web: [www.daveweb.com.au](http://www.daveweb.com.au)

Distributed in Australia by  
LOCK AND KEY a division of the  
DAYCOR GROUP PTY LTD ABN 95 003 562 598  
This product has been manufactured in China  
to Lock and Key Company specifications

This product is guaranteed to be free from defects in materials and workmanship for a period of one (1) year from the date of original purchase. This warranty is for replacement of product only and Lock and Key Company does not accept responsibility for any direct or consequential damage caused by this product or its use. This warranty

does not cover damage that results from faulty installation or usage, alteration or modification of the product or tarnishing of the finish, including colour change due to weather, salt or chemical. Should this product not perform satisfactorily in its intended application, return it to place of purchase for replacement.