

SHOWCASE LOCK INSTALLATION INSTRUCTIONS

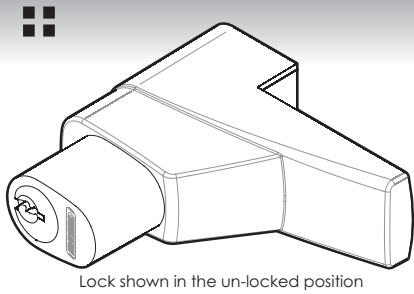

OPERATION MODES

- SNAP LOCK MODE
- LOCK OPEN / LOCK CLOSED MODE
- KEY RETAIN MODE (as packaged)

TOOLS REQUIRED

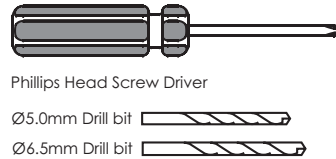

CONTENTS

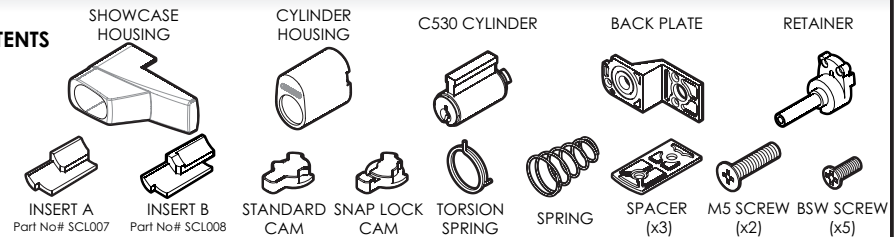

SNAP LOCK MODE

TORSION SPRING, INSERT B & SNAP LOCK CAM

CYLINDER ASSEMBLY

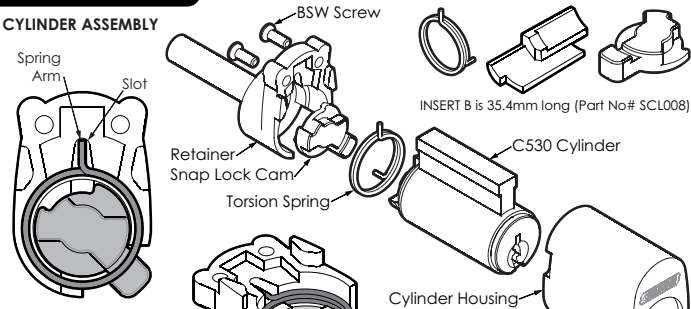

1. INSERTING THE SNAP LOCK CAM AND TORSION SPRING

Insert the snap lock cam into the retainer, and place the torsion spring on top of the cam. Tension the spring, until the spring arm is in the slot.

2. ATTACHING THE RETAINER

Insert the retainer with cam (standard or snap lock cam) into the back of the cylinder housing with C530 cylinder inside. Screw on with 2 x BSW screws.

3. INSERTING THE INSERT

Slide the appropriate insert into the bottom of the lock.

LOCK OPEN / LOCK CLOSED MODE

INSERT A & STANDARD CAM

CYLINDER ASSEMBLY

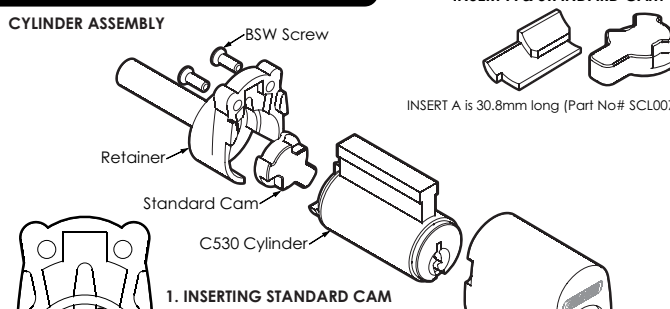

1. INSERTING STANDARD CAM

Insert the snap lock cam into the retainer. (no spring required)

2. ATTACHING THE RETAINER

Insert the retainer with cam (standard or snap lock cam) into the back of the cylinder housing with C530 cylinder inside. Screw on with 2 x BSW screws.

3. INSERTING THE INSERT

Slide the appropriate insert into the bottom of the lock.

KEY RETAIN MODE

INSERT B & STANDARD CAM

CYLINDER ASSEMBLY

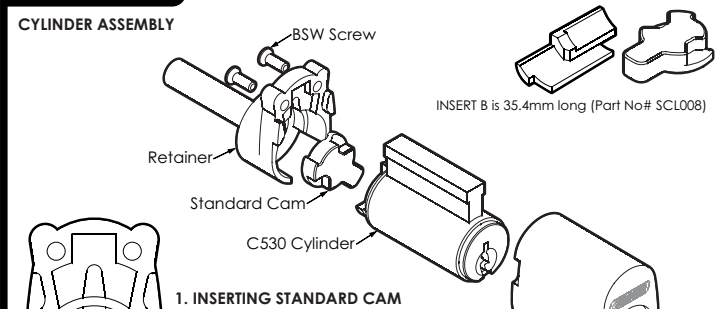

1. INSERTING STANDARD CAM

Insert the snap lock cam into the retainer. (no spring required)

2. ATTACHING THE RETAINER

Insert the retainer with cam (standard or snap lock cam) into the back of the cylinder housing with C530 cylinder inside. Screw on with 2 x BSW screws.

3. INSERTING THE INSERT

Slide the appropriate insert into the bottom of the lock.

4. INSERTING THE CYLINDER

5. INSERTING THE SPRING

Insert the cylinder assembly with the insert in position. Once in place, unlock the cylinder assembly, and slide the cylinder assembly until it is in the unlocked position.

Insert the compression spring from the bottom of the lock, around the retainer pin. The cylinder assembly should be unlocked and the spring should sit almost flush with the bottom of the lock housing.

6. ATTACHING THE BACK PLATE

Once the cylinder assembly is in place (in the un-locked position) and the compression spring is inside the lock, the back plate is placed over the spring & retainer pin. Screw on with 3 x BSW screws. The back plate also secures the insert in place.

7. FIXING & SPACER ASSEMBLY

Utilizing a Ø5mm drill bit, drill two holes 25mm apart. Using the two M5 screws, attach the lock onto a showcase &/or cabinet door. A spacer may be required, depending on showcase/cabinet door thickness. A M4 pin extensions are available. (code LPLEXTSM)

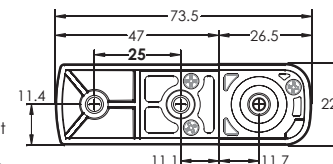

WARNING
Please keep contents away from small children, may lead to suffocation.

NOTE
Please dispose of plastic bags & other packaging in a thoughtful manner.

