

CARBINE LOCKABLE BOLT "REVERSING" THE LOCK



DISMANTLING THE LOCK

1. a: Remove the bolt by following these steps;
 - b: Insert the long end of the Carbine Pin Punch through the hole in the main body (next to the knob) and drive the roll pin out of the bolt.
 - c: Turn the key and remove the bolt.
2. Unscrew the back plate & remove all internal components from the main body.
3. With the key removed from the cylinder, unscrew the cam.

(NOTE: If the key is left in the cylinder, the barrel, springs & pins will fall out.)

RE - ASSEMBLING THE LOCK

1. Refer to the illustrations overleaf & assemble as required.
2. Fix the cam to the cylinder.
3. Fit the spring & locking pawl into the slot.
4. Locate the cylinder in the housing ensuring that the roll pin is butted up against the side wall.
5. Fix the back plate with countersunk screws.
6. Replace the bolt to the unlocked position, using the key to retract the locking mechanism. Refit the roll pin through the hole in the main body (next to the knob). Using the short end of the Carbine Pin Punch, drive the roll pin into the bolt until the punch body gently contacts the housing. Check for free movement of the bolt.

LEFT HAND ASSEMBLY BOLT DOWN

NOTE: Bolt is on Left



LEFT HAND ASSEMBLY BOLT UP

NOTE: Bolt is on Left

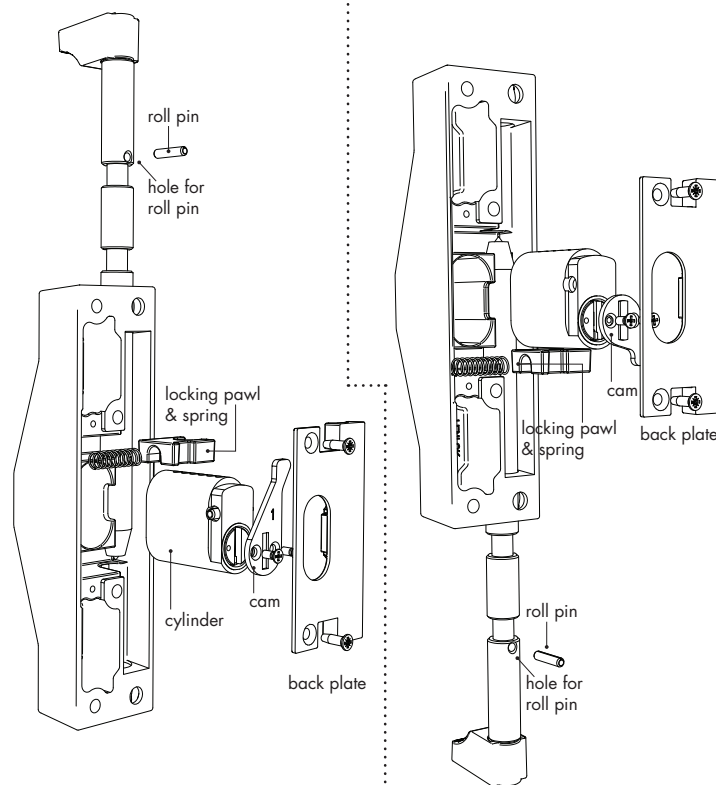

RIGHT HAND ASSEMBLY BOLT DOWN

NOTE: Bolt is on Right



RIGHT HAND ASSEMBLY BOLT UP

NOTE: Bolt is on Right

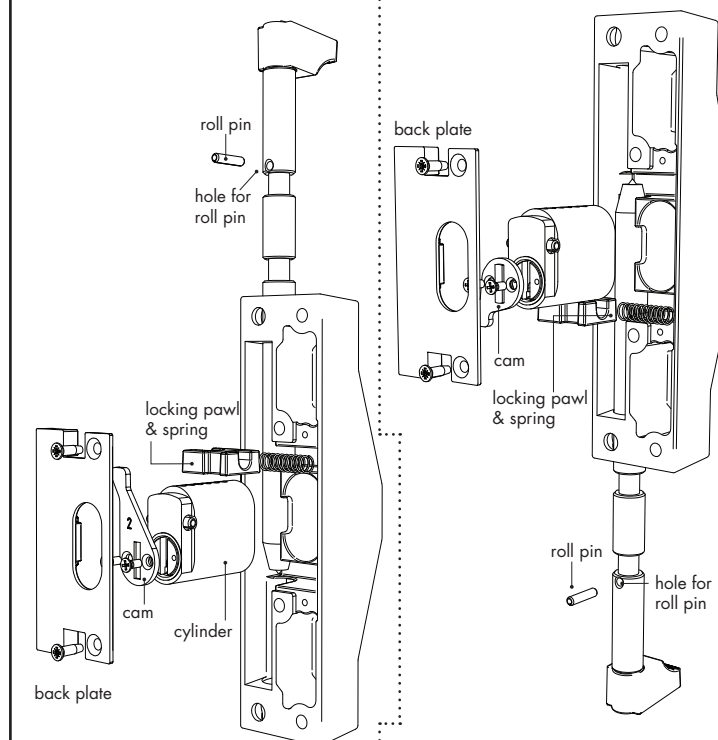



Concealed mounting instructions

1. Position lock on door with Locking Bolt to the outside edge.
2. Mark around the body of the lock to show position.
3. Apply "Self Adhesive" template to the marked position, allowing for the border on the template.
4. Drill 6.5mm (1/4") diameter holes through the door at positions marked "A, B & C" on the template. Ensure that the retainer pin hole is drilled to allow removal of the retaining pin for future demounting of the lock.
5. To remove bolt from lock:
 - a: Slide the bolt to the unlocked position
 - b: Insert the long end of the Carbine Pin Punch through the hole in the main body (next to knob) and drive the roll pin out of the bolt.
 - c: Turn the key and remove bolt.
6. Remove self adhesive template from door and fix the lock through the rear using the supplied M6 hex bolts. Fit the M6 counter sunk machine screws through the front to secure the concealed fixing plate.
7. Replace the bolt to the unlocked position, using the key to retract the locking mechanism. Refit the roll pin through the hole in the main body (next to knob). Using the short end of the Carbine Pin Punch, drive the roll pin until the punch body gently contacts the housing. Check for free movement of bolt.
8. Fit strike plate, as required.

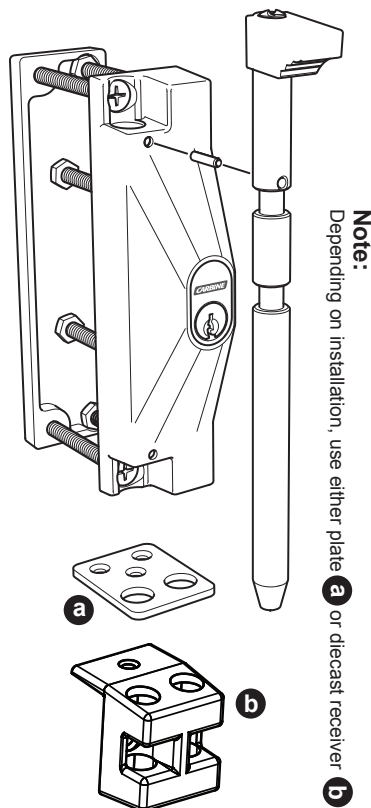

Front Fix mounting instructions

1. Position lock on door as required.
2. Mark around the body of the lock to show position.
3. Apply "Self Adhesive" template to the marked position, allowing for the border on the template.
4. Drill 4mm (5/32") dia. holes in the positions marked "A & on the template. Ensure that the retainer pin hole is drilled to allow removal of the retaining pin for future demounting of the lock.
5. To remove bolt from lock:
 - a: Slide the bolt to the unlocked position.
 - b: Insert the long end of the Carbine Pin Punch through the hole in the main body (next to knob) and drive the roll pin out of the bolt
 - c: Turn the key and remove bolt.
6. Remove self adhesive template from door. Using the 2 large gauge screws supplied, mount the lock through the two holes, which have been exposed by the removal of the bolt.
7. Replace the bolt to the unlocked position, using the key to retract the locking mechanism. Refit the roll pin through the hole in the main body (next to knob). Using the short end of the Carbine Pin Punch, drive the roll pin until the punch body gently contacts the housing. Check for free movement of bolt.
8. Fit strike plate, as required using the 3 small gauge screws.

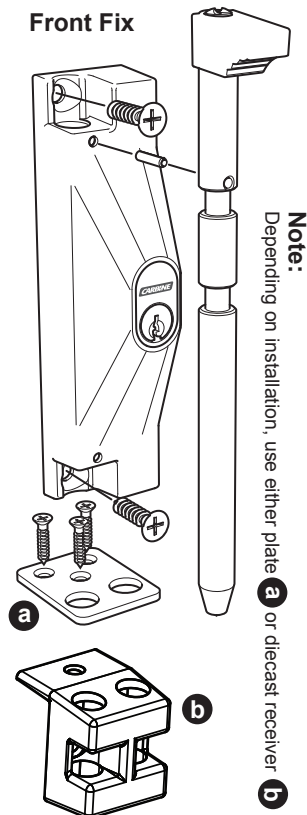

Rear fixing, using break head bolts, (can be purchased separately, Part code 3512)

Note – This fixing method may be used with or without front fixing.
Follow concealed mounting instructions to the end of point 5.

6. Remove self adhesive template from door. Before mounting the lock we recommend using "LOCTITE 222" on the threads of the supplied break head bolts. Tension the bolts until the heads break off. see fastener cut down guide

Fastener cut down guide

cut fasteners to,



| door thickness + 12mm



| from this line

Always ensure safety
equipment is used when
installing this product

